

# ECOKRAFT BRIQUETTING PRESS BP

## COMPACT, RELIABLE AND FLEXIBLE



### AREAS OF APPLICATION

The ECOKRAFT briquetting presses BP30-70 are suitable for the briquetting of wood shavings, milling chips, sawdust, wood dust, wood chips (shredded), paper and polystyrene.

The produced compact briquettes save storage and transport costs and can be energetically recycled. Depending on throughput and material the briquetting presses can individually adapted to the task will be.

### ADVANTAGES

- ✓ Compact size
- ✓ High value enhancement through transformation of raw materials
- ✓ Simple operation
- ✓ Suitable for mixed materials
- ✓ SPS control for a fully automated operation
- ✓ Optional oil cooling for Multi-shift operation

### ECOKRAFT BRIQUETTING PRESS BP

The briquetting presses offer an ideal solution, as briquettes can be stored and transported easily and in a space-saving manner. Furthermore, a spontaneous ignition a lot less. The briquetting presses require little space, are robustly built and equipped with low-maintenance technology. No matter if wood, paper, biomass, foam or polystyrene. With a throughput of up to 130 kg/h, they are particularly suitable for small and medium-sized companies. Versatile installation options due to the availability of left and right-hand versions.



Briquette diameter: 30 - 70 mm



Permanently rotating agitator with output screw for conveying to the pressing unit

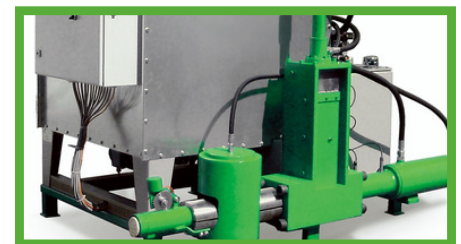

Dust-tight filling shaft with sensors for a disruption-free operation



## SPECIFICATIONS

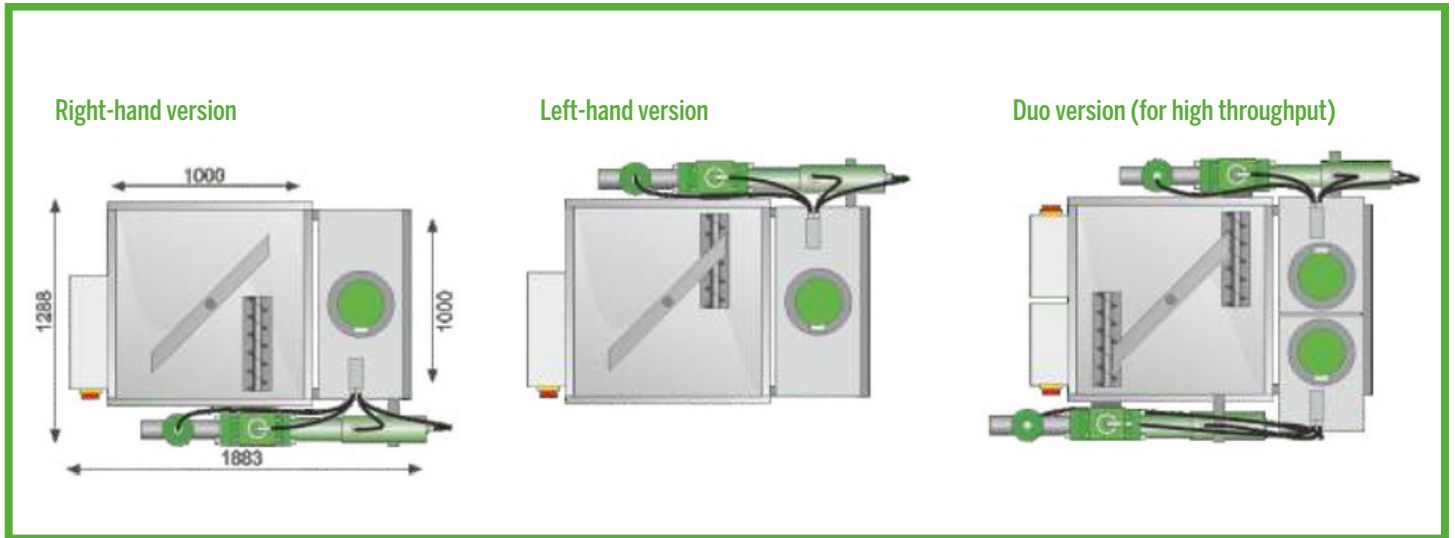

TYPE	BP30	BP50	BP60	BP70
<b>Weight</b>	ca. 800 kg	ca. 750 kg	ca. 750 kg	ca. 900 kg
<b>Drive</b>	max. 4 kW/h	max. 5,5 kW/h	max. 5,5 kW/h	max. 7,5 kW/h
<b>Briquette diameter</b>	30 mm	50 mm	60 mm	70 mm
<b>Funnel size</b>	1,040 x 1,040 mm	1,000 x 1,000 mm	1,000 x 1,000 mm	1,000 x 1,000 mm
<b>Power voltage</b>	380 - 420 V	380 - 420 V	380 - 420 V	380 - 420 V
<b>Screw conveyor channel</b>		150 x 150 mm	150 x 150 mm	150 x 150 mm
<b>Productivity per hour**</b>	<b>up to 50 kg</b>	<b>up to 70 kg</b>	<b>up to 80 kg</b>	<b>up to 130 kg</b>

All technical data without guarantee - subject to technical changes!

\* Depending on equipment

\*\* Productivity depends on material and residual moisture; residual moisture should not exceed 18%

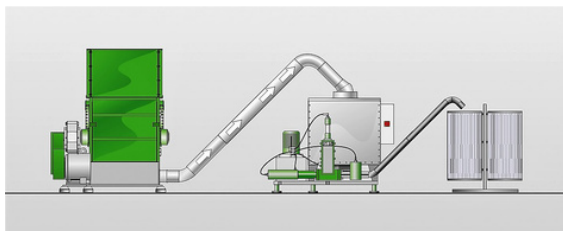

Material feeding of residual wood into chipper & shredding into chips

By means of a screw conveyor the chips are transported into the briquetting press

Pressed briquettes are collected in a bagging plant

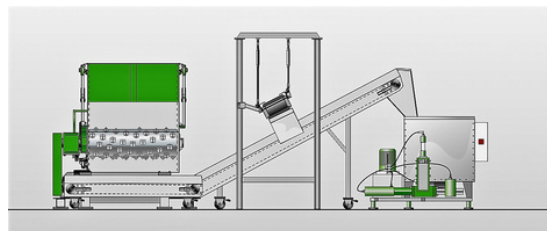

Material feed of waste and residual wood

Removal of impurities such as metal

Briquetting

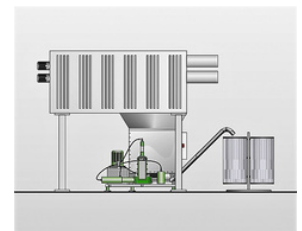

Use under an extraction or filter system for compressing the dusts

Product illustrations similar; Changes possible at any time; All information without guarantee; Acceptance by ECOKRAFT AG applies; Status: 06/2022

